

REV	LOCATIONS	DESCRIPTION	DATE	REVISOR	APPD

SPECIFICATIONS

Electrical
 Current Rating: 0.5A AC(rms)/DC
 Voltage Rating: 25V AC(rms)/DC
 Contact Resistance: 30 mΩ Max
 Insulation Resistance: 500 MΩ MIN
 Withstanding Voltage: 200V AC r.m.s
 Temperature Range—Operating: -25°C~+85°C

Material And Plating
 Housing: Thermoplastic UL94V-0/ Natural
 Actuator: Thermoplastic UL94V-0/ Black
 Contact: Copper Alloy/ Gold plated/ Gold in contact area, matte tin on tail
 LEG: Copper Alloy/ Tin plated

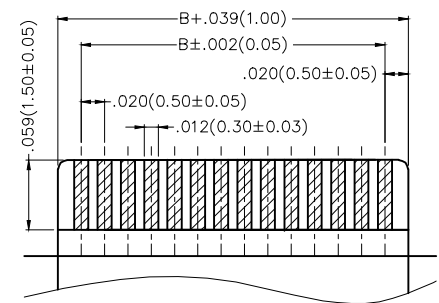
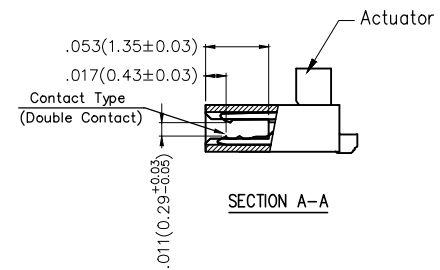
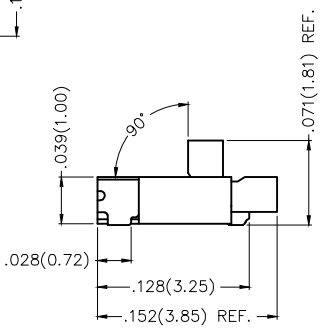
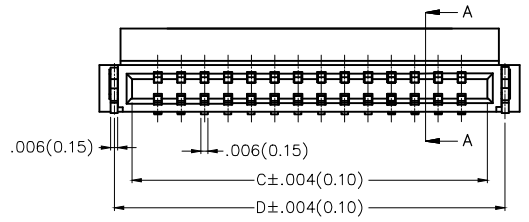
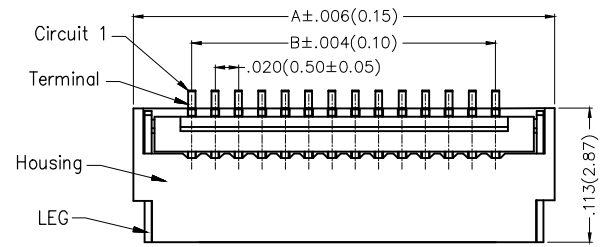

Applicable FFC
 Recommended Dimension
 Thickness .012(0.30±0.03)

Ordering Information

FFC	050	35	—	XX	S	B	D	1	X	3	W5	M
1	2	3	4	5	6	7	8	9	10	11	12	

1 Category FFC-FPC	2 Series Number 050-Pitch 0.50mm	3 Distinction No. 35	4 Circuits XX	5 Assemble Layout S-SMT	6 Entry Angle B- 90° Angle
7 Contact Type D-Double Contact	8 ZIF 1-ZIF	9 Plating 1-Gold plated 3-Gold in contact area, matte tin on tail	10 Material-Resin 3-LCP	11 Color-Resin W5-Housing: Natural, Actuator: Black	12 Packaging M-Reel

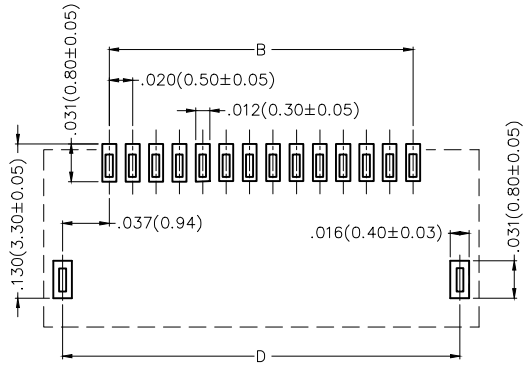

Recommended P.C.Board Layout

THIRD ANGLE PROJECTION	GENERAL TOLERANCES (UNLESS SPECIFIED)		APPROVE BY FRANK	DATE 18/JUN/13	PART NO. FFC05035-XXSBD1X3W5M	ITEM NO. FFC05035
	X.±.012(0.30)	X'.±5'	CHECKED BY CHERRY	DATE 18/JUN/13	TITLE FPC/FFC connector 0.5mm Double contact SMT	
DESIGN UNITS Inch (metric)	X.XX±.008(0.20)	X'.±2'	DRAWN BY KATE	DATE 18/JUN/13	REV 0	SHEET NO. 1/3
SCALE 5:1	X.XX±.006(0.15)	.XX'±1"	东莞市铈高电子制品有限公司			
SIZE A4	X.XXX±.004(0.10)	.XXX'±0.5'				

REV	LOCATIONS	DESCRIPTION	DATE	REVISER	APPD

Note: Gold in contact area, matte tin on tail						Note: Contact gold plated					
Circuits (n)	Part No.	Dimensions(in/mm)				Circuits (n)	Part No.	Dimensions(in/mm)			
		A	B	C	D			A	B	C	D
4	FFC05035-04SBD133W5M	.157(4.00)	.059(1.50)	.102(2.60)	.133(3.37)	4	FFC05035-04SBD113W5M	.157(4.00)	.059(1.50)	.102(2.60)	.133(3.37)
6	FFC05035-06SBD133W5M	.197(5.00)	.098(2.50)	.142(3.60)	.172(4.37)	6	FFC05035-06SBD113W5M	.197(5.00)	.098(2.50)	.142(3.60)	.172(4.37)
8	FFC05035-08SBD133W5M	.236(6.00)	.138(3.50)	.181(4.60)	.211(5.37)	8	FFC05035-08SBD113W5M	.236(6.00)	.138(3.50)	.181(4.60)	.211(5.37)
10	FFC05035-10SBD133W5M	.276(7.00)	.177(4.50)	.220(5.60)	.251(6.37)	10	FFC05035-10SBD113W5M	.276(7.00)	.177(4.50)	.220(5.60)	.251(6.37)
12	FFC05035-12SBD133W5M	.315(8.00)	.217(5.50)	.260(6.60)	.290(7.37)	12	FFC05035-12SBD113W5M	.315(8.00)	.217(5.50)	.260(6.60)	.290(7.37)
14	FFC05035-14SBD133W5M	.354(9.00)	.256(6.50)	.299(7.60)	.330(8.37)	14	FFC05035-14SBD113W5M	.354(9.00)	.256(6.50)	.299(7.60)	.330(8.37)
15	FFC05035-15SBD133W5M	.374(9.50)	.276(7.00)	.319(8.10)	.349(8.87)	15	FFC05035-15SBD113W5M	.374(9.50)	.276(7.00)	.319(8.10)	.349(8.87)
16	FFC05035-16SBD133W5M	.394(10.00)	.295(7.50)	.339(8.60)	.369(9.37)	16	FFC05035-16SBD113W5M	.394(10.00)	.295(7.50)	.339(8.60)	.369(9.37)
18	FFC05035-18SBD133W5M	.433(11.00)	.335(8.50)	.378(9.60)	.408(10.37)	18	FFC05035-18SBD113W5M	.433(11.00)	.335(8.50)	.378(9.60)	.408(10.37)
20	FFC05035-20SBD133W5M	.472(12.00)	.374(9.50)	.417(10.60)	.448(11.37)	20	FFC05035-20SBD113W5M	.472(12.00)	.374(9.50)	.417(10.60)	.448(11.37)
24	FFC05035-24SBD133W5M	.551(14.00)	.453(11.50)	.496(12.60)	.526(13.37)	24	FFC05035-24SBD113W5M	.551(14.00)	.453(11.50)	.496(12.60)	.526(13.37)
26	FFC05035-26SBD133W5M	.591(15.00)	.492(12.50)	.535(13.60)	.566(14.37)	26	FFC05035-26SBD113W5M	.591(15.00)	.492(12.50)	.535(13.60)	.566(14.37)
30	FFC05035-30SBD133W5M	.669(17.00)	.571(14.50)	.614(15.60)	.644(16.37)	30	FFC05035-30SBD113W5M	.669(17.00)	.571(14.50)	.614(15.60)	.644(16.37)
34	FFC05035-34SBD133W5M	.748(19.00)	.650(16.50)	.693(17.60)	.723(18.37)	34	FFC05035-34SBD113W5M	.748(19.00)	.650(16.50)	.693(17.60)	.723(18.37)
40	FFC05035-40SBD133W5M	.866(22.00)	.768(19.50)	.811(20.60)	.841(21.37)	40	FFC05035-40SBD113W5M	.866(22.00)	.768(19.50)	.811(20.60)	.841(21.37)



 THIRD ANGLE PROJECTION	GENERAL TOLERANCES (UNLESS SPECIFIED)		APPROVE BY	DATE	PART NO.	ITEM NO.	REV 0	SHEET NO. 2/3
	X.±.012(0.30)	X.'±5'	FRANK	18/JUN/13	FFC05035-XXSBD1X3W5M	FFC05035		
	X.X±.008(0.20)	X.'±2'	CHECKED BY	DATE	TITLE			
	X.XX±.006(0.15)	.XX'±1"	CHERRY	18/JUN/13	FPC/FFC connector 0.5mm Double contact SMT			
SCALE 5:1	SIZE A4	X.XXX±.004(0.10)	.XX'±0.5'	DRAWN BY	DATE	东莞市铀高电子制品有限公司		
				KATE	18/JUN/13			

REV	LOCATIONS	DESCRIPTION	DATE	REVISER	APPD

Note:

1. 10 sprocket hole cumulative tolerance ± 0.2
2. Carrier camber is within 1.0mm in 250mm
3. Material: White Conductive polystyrene Alloy 100% recyclable
4. All dimensions meet EIA-481-3 requirements
5. Peel off force of cover tape & carrier tape: 20g~130g (0.2N~1.3N)
6. Component load per 13" reel: 3,500 pcs
7. Minimum Order Quantity:
Gold in contact area, matte tin on tail: 3,500 pcs ;
Gold Plated: 35,000 pcs

Circuits (n)	Dimensions (in/mm)		
	A	B	C
4~8	630(16.0)	.295(7.50)	—
9~24	.945(24.0)	.453(11.50)	—
25~36	1.260(32.0)	.561(14.25)	1.122(28.50)
37~40	1.732(44.0)	.797(20.25)	1.594(40.50)

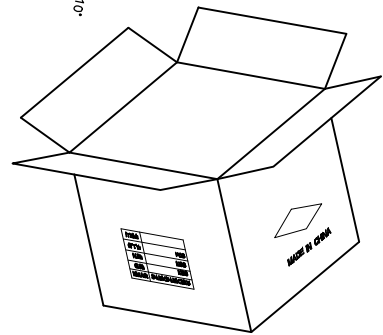
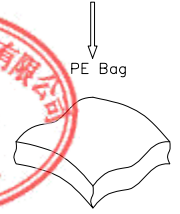
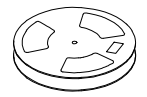
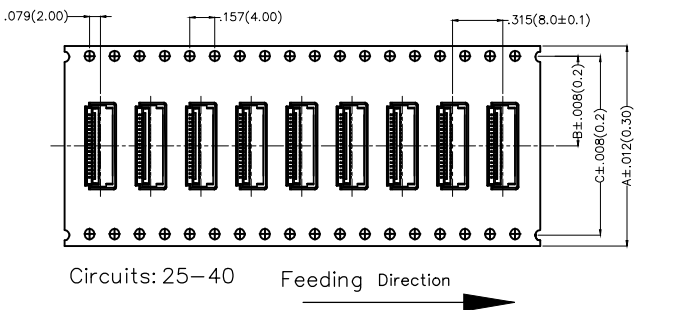
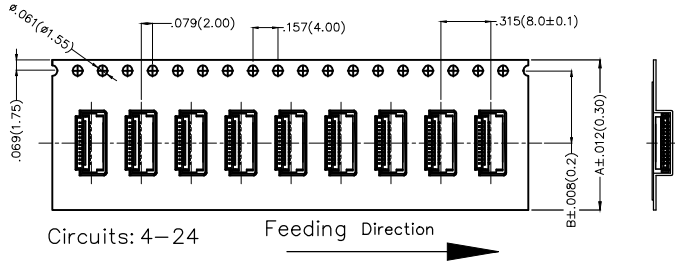
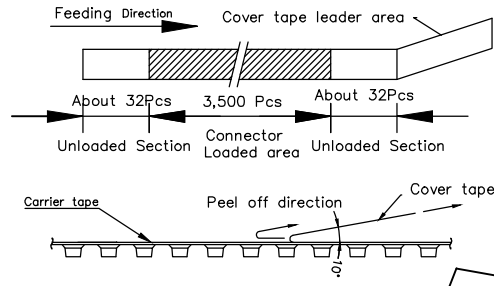
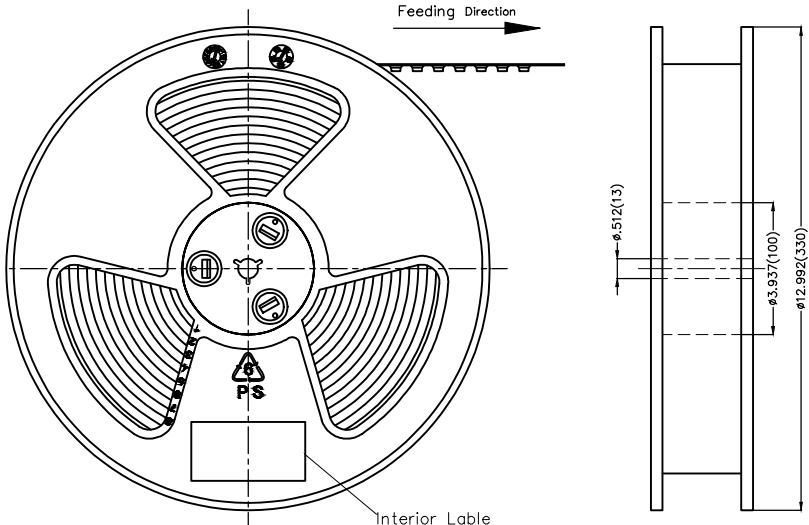

 THIRD ANGLE PROJECTION DESIGN UNITS Inch (metric) SCALE 5:1 SIZE A4	GENERAL TOLERANCES (UNLESS SPECIFIED)		APPROVE BY	DATE	PART NO.	ITEM NO.	REV 0	SHEET NO. 3/3
	X. $\pm 0.12(0.30)$	X. $\pm 5^\circ$	FRANK	18/JUN/13	FFC05035-XXSBD1X3W5M	FFC05035		
	X.X $\pm 0.008(0.20)$	X. $\pm 2^\circ$	CHECKED BY	DATE	TITLE		FFC/FFC connector 0.5mm Double contact SMT	
	X.XX $\pm 0.006(0.15)$.XX $\pm 1^\circ$	JACOB	18/JUN/13	东莞市铀高电子制品有限公司 东 莞 市 铀 高 电 子 制 品 有 限 公 司			
X.XXX $\pm 0.004(0.10)$.XXX $\pm 0.5^\circ$	DRAWN BY	DATE					
		CERRY	18/JUN/13					