

5	6	7	8	9
版本 REV	编号 ECON NO.	位置 LOCATIONS	变更内容 DESCRIPTION	日期 DATE
A0				

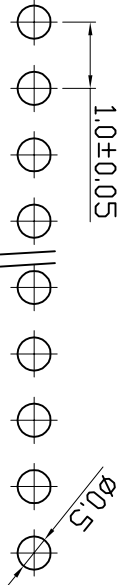
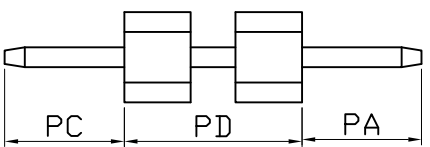
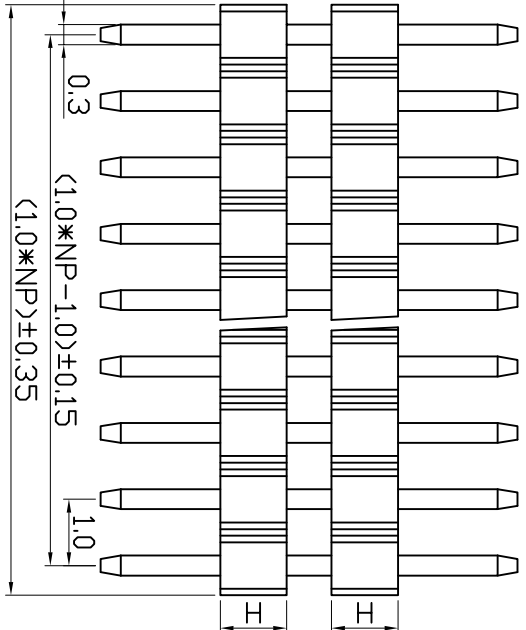
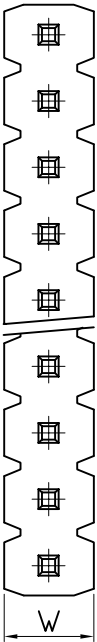

PCB LAYOUT

Specifications

1. Current Ratings: 1amps
2. Insulation Resistance: 1000 MΩ min.
3. Dielectric withstanding Voltage: AC 500V
4. Contact Resistance: 30 mΩ max.
5. Operating Temperature: -25°C to +85°C
6. Contact Material: Brass
7. Insulation Material: Asfollows
8. Plated: Asfollows

Ordering Information



东莞市铷高电子制品有限公司

TOLERANCE UNLESS OTHERWISE SPECIFIED		品名 TITLE:		PHL 09# 180° 单排双翘排针		制图 (D):		日期 (Date):	
LITER		ANGLES		料号 (P/N):		审核 (CHKD):		日期 (Date):	
.0 ±0.3		0° ±2.0°		文件编号 (D/N):		核准 (APPD):		日期 (Date):	
.00 ±0.2		.0° ±1.0°		比例 (SCALE):		张数 (SHEET):		SIZE: A4	
.000 ±0.1		.00° ±0.5°		1:1		XORFX		板别 TYPE:	
				单位 (UNITED):		mm			