

ROHS

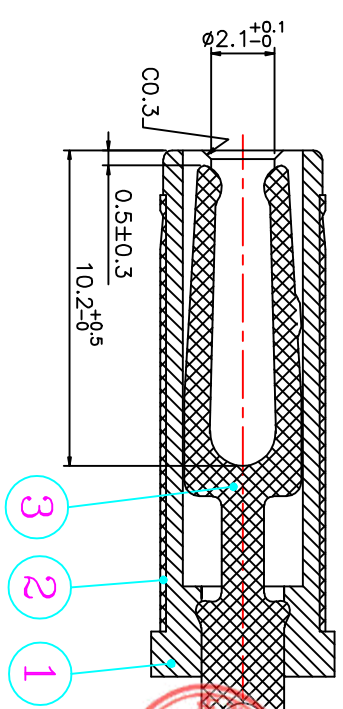
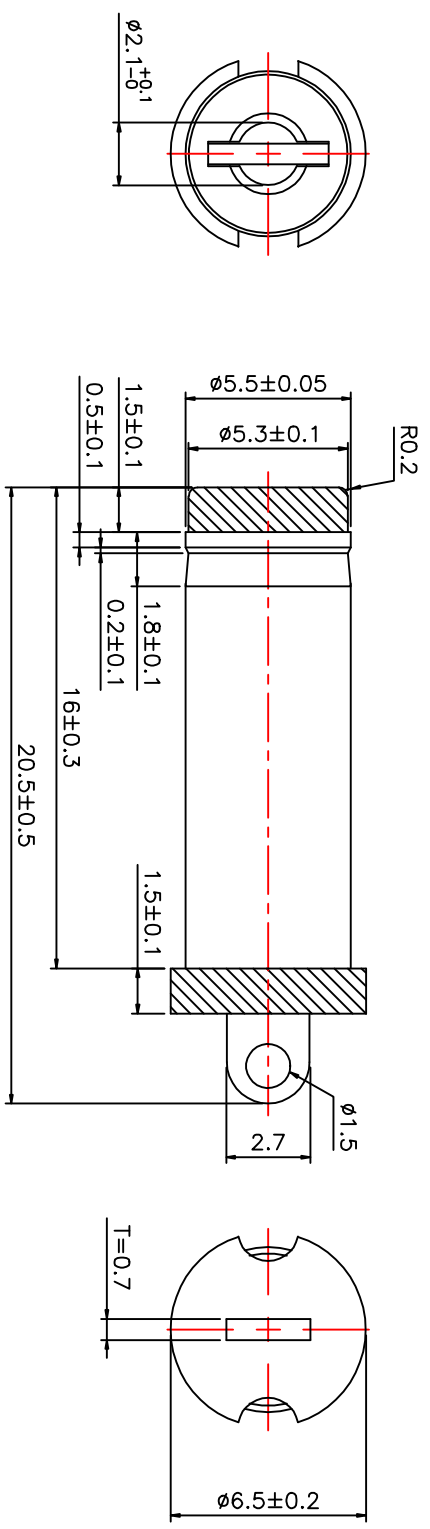

Request:  
 1.Outgoing:No burr, no hurt.  
 2.Electronic performance:  
 a:Insulation resistance: Above DC500V/100MΩ;  
 b:Endure voltage:AC500V at 1 minute;  
 c>Contact resistance:Under 30mΩ;  
 3.Insertion force & withdrawal force:0.3-3kgf.  
 4.Salt spray test:24h.  
 5.Meet RoHS.  
 6.Remark \* is important specification.

REV	修正描述 REV.LTR	修正前 BEFORE REVISION	修正后 AFTER REVISION	签名 SIGN	日期 DATE
V1.0		新版制定		June	20200317

单位 Unit	一般公差 The general tolerance	7	核准 APPROVED BY	校对 CHECKED BY	制图 DRAWN BY	东莞市铨高电子有限公司			
mm			June	杨义邦	李莹峰	规格 DESCRIPTION:	DC PLUG 2.1*20.5		
比例 Scale	XX:±0.3	5				品名 P/N:	5521TV205YE		
视图 Third angle projection	XX:±0.1	3				图号 DRAWN NO:	CP-01-0087		
	.XX:±0.05	1							
		NO.							

