

ROHS

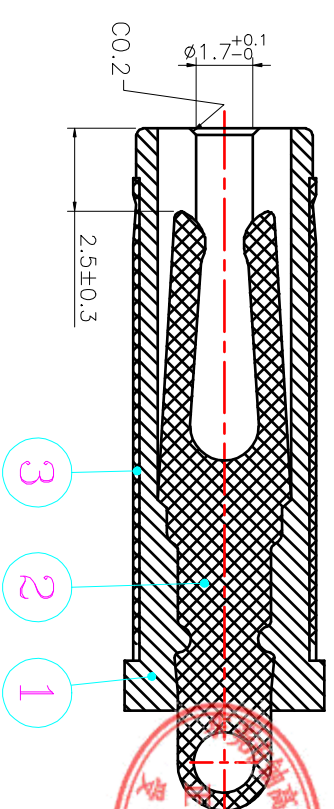
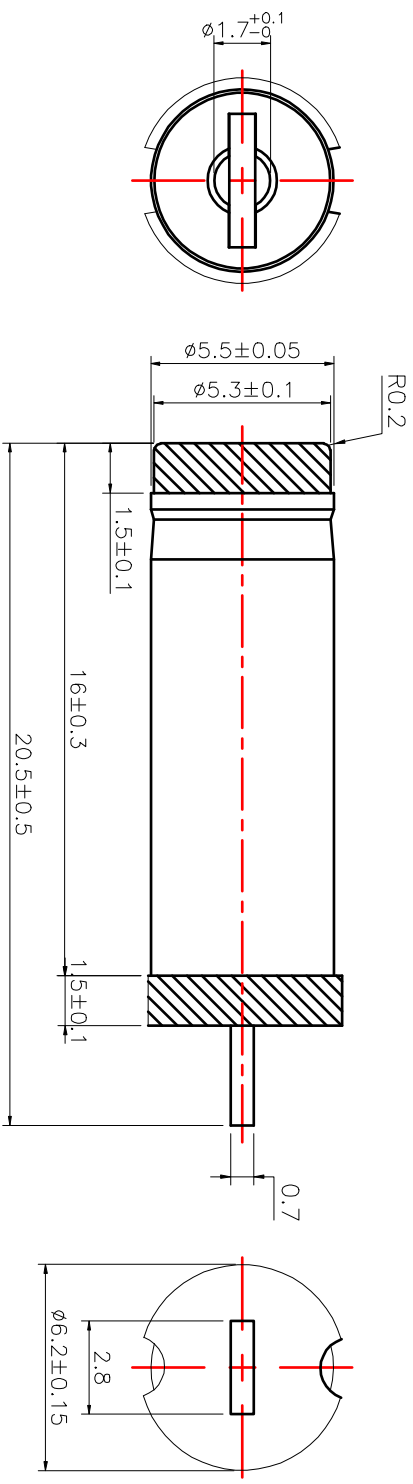

**Technology Request:**

- 1.Outlook:No burr, no hurt.
- 2.Electronic performance:
- a:insulation resistance:  
Above DC500V/100MΩ;
- b:Endure voltage:AC500V at 1 minute;
- c:Contact resistance:Under 30mΩ;
- 3.Insertion force & withdrawal force:0.3–3kgf.
- 4.Salt spray test:24H.
- 5.Meet RoHS.
- 6.Remark \* is important specification.

比例 Scale	5:1
第三角 Third angle projection	X:X:±0.1
	.XX:±0.05

7	公差 Unit	一般公差 The general tolerances
6	比例 Scale	XX:±0.3
5	第三角 Third angle projection	X:X:±0.1
4		.XX:±0.05
3		
2		
1		

7	核准 APPROVED BY	June
6	校对 CHECKED BY	杨义邦
5	制图 DRAWN BY	李雪峰

规格 DESCRIPTION:	DC PLUG $\phi 5.5 \times 1.7 \times 20.5$
品名 P/N:	5517TV205M25
图号 DRAWN NO.:	CP-01-0079

版本 REV	修正标识 REV.LTR	修正前 BEFORE REVISION	修正后 AFTER REVISION	签名 SIGN	日期 DATE
V1.0		核准制定		June	20190105