

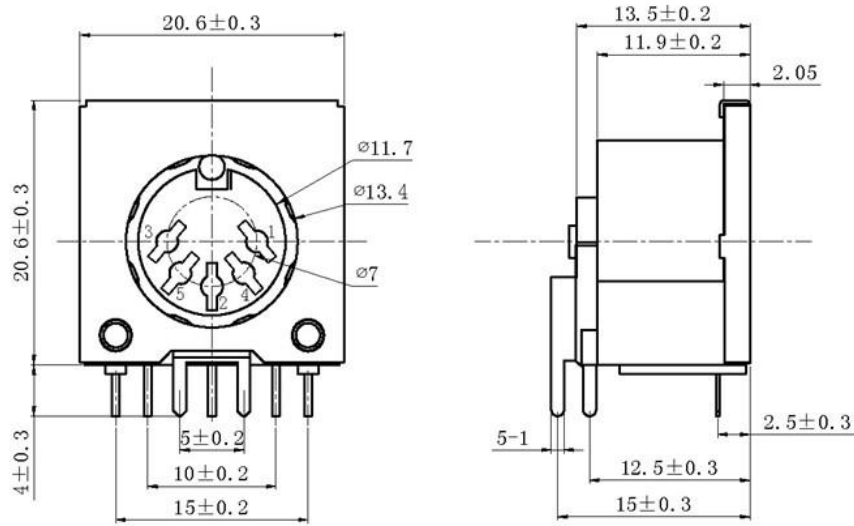

RoHS
Compliant
2002/95/EC

REV.	ECN.	NO.	APPD.

DIMENSIONS



PCB板安装孔图

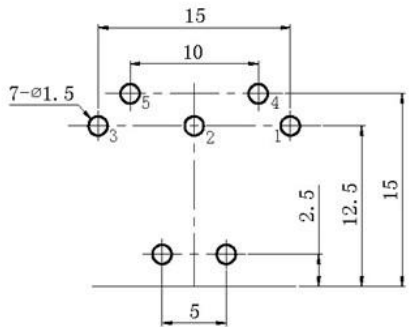

ELECTRO-MECHANICAL CHARACTERISTICS

Refer to additional specifications

1	额定负荷Rated load	100V 2A DC
2	接触电阻Contact resistance	$\leq 30m \Omega$
3	绝缘电阻Insulation resistance	$\geq 100M\Omega$
4	耐压Withstand Voltage	AC 250V(50HZ) /1min
5	电器寿命Life	≥ 5000 cycle
6	动作力度Strength of action	5-50N You can customize it
7	环境温度The environment temperature	$-15 \sim 75^{\circ}C$
8	相对湿度Relative humidity	$\leq 95\% (40^{\circ}C)$
9		
10		
11		



NO	配件Accessories	材料名称Material	产地Place of origin	备注Note	WITHIN 1.5mm: $\pm 0.1mm$	UNIITS mm	东莞市铀高电子制品有限公司					
1	上盖/基座 Topcover/base	PBT	进口/国产 Imports / domestic	黑/白Black/white	OVER 1.5mm: $\pm 0.2mm$	MAT'L	TITLE: PUSH SWITCH / VERTICAL		PART NO.: YK-5-02BA			
2	塑胶内件 interior	PBT	进口/国产 Imports / domestic	黑/白Black/white		SEE NOTE	DR: Ricky 2015/03/23		DWG NO.:			
3	端子/拉伸件 Terminals/stretchers	H62黄铜 Brass	进口/国产 Imports / domestic	CU/Ni /SN		FINISH	CHKD: Ricky 2015/03/23		SCALE SHEET REV. CUSTOMER			
4	短针 Short needle	H62黄铜 Brass	进口/国产 Imports / domestic	CU/Ni /SN		SEE NOTE	APPD:		4:1	1/1	A	DRAWING
5	中针 Middle Needle	H62黄铜 Brass	进口/国产 Imports / domestic	CU/Ni /SN		Q'TY						
6	长针 Long needle	H62黄铜 Brass	进口/国产 Imports / domestic	CU/Ni /SN								

THESE DRAWINGS AND SPECIFICATIONS ARE THE PROPERTY OF ACCURATE 3K-KAMING(LANG LUN) INC. AND SHALL NOT BE REPRODUCED, COPIED OR USED IN ANY MANNER WITHOUT THE PRIOR WRITTEN CONSENT OF ACCURATE 3K-KAMING(LANG LUN) INC.

